

SMD Power Inductor

CDEPH6211



特点

- Magnetically shielded
- Flat wire windings provide exceptionally low DC resistance
- L×W×H: 10.0×6.5×11.5mm Max.
- Product weight: 3.27g(Ref.)
- Moisture Sensitivity Level: 1

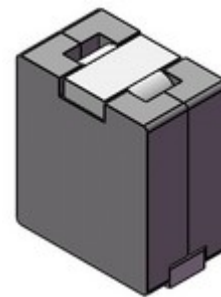

环境规格

- Operating temperature range: $-40^{\circ}\text{C} \sim +125^{\circ}\text{C}$ (Including coil's temperature rise.)
- Storage temperature range : $-40^{\circ}\text{C} \sim 125^{\circ}\text{C}$

包装

- Carrier tape and reel packaging
- 13.0" diameter reel
- 250pcs per reel

用途

- Multi-phase and V core regulators.
- Voltage Regulator Modules (VRMs) and highpower density VRMs.
- Data networking and storage systems.
- Graphics cards and battery power systems.

外形尺寸 - [mm]

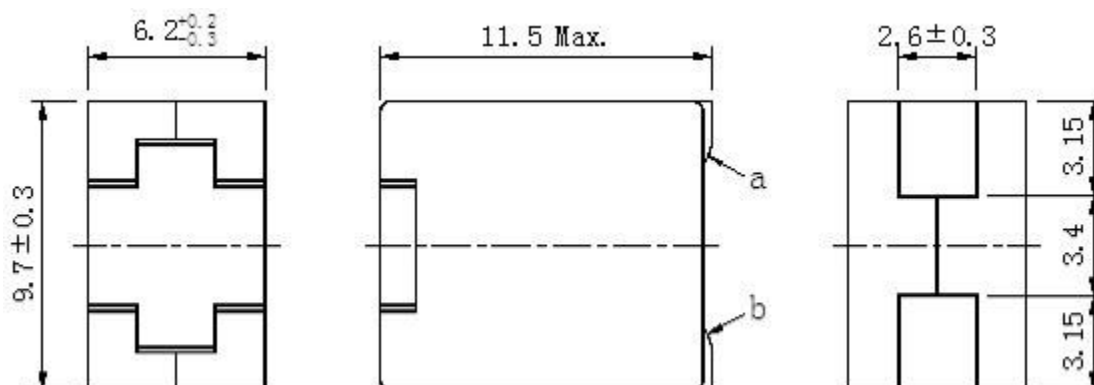

SMD Power Inductor

CDEPH6211



推荐焊盘尺寸 - [mm]

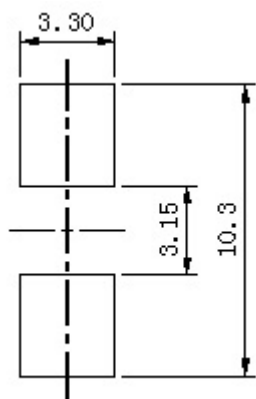

接线图 (底面)

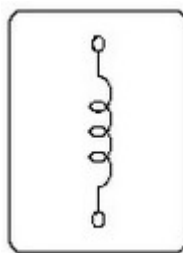



电气特性规格

品名	电感值 [within] (μ H) ※1	直流电阻 (20℃) Max. (Typ.) (m Ω)	饱和电流 (A) Max. (Typ.) ※2		温度上升电流 (A) Max. (Typ.) ※3
			20℃	100℃	
CDEPH6211NP-R10LC	0.10 \pm 15%	(0.125)	(115)	(110)	85.00 (85.00)
CDEPH6211NP-R12LC	0.12 \pm 15%	(0.125)	(112)	(92.00)	85.00 (85.00)
CDEPH6211NP-R15LC	0.15 \pm 15%	(0.125)	(92.00)	(75.00)	85.00 (85.00)
CDEPH6211NP-R32LC	0.32 \pm 15%	(0.125)	(40.00)	(34.00)	85.00 (85.00)

※1 Measuring frequency inductance at 1MHz.

※2 Saturation current: This indicates the value of D.C. current when the inductance becomes 20% lower than its initial value.

※3 Temperature rise current: The value of D.C. current when temperature of coil increased $\Delta T=40^{\circ}\text{C}$ ($T_a=20^{\circ}\text{C}$).

回流焊耐热与推荐温度曲线图

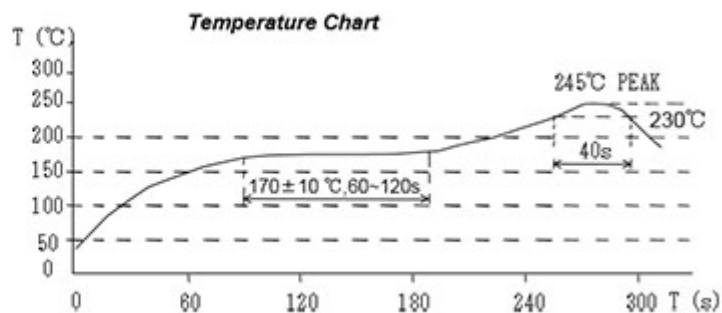
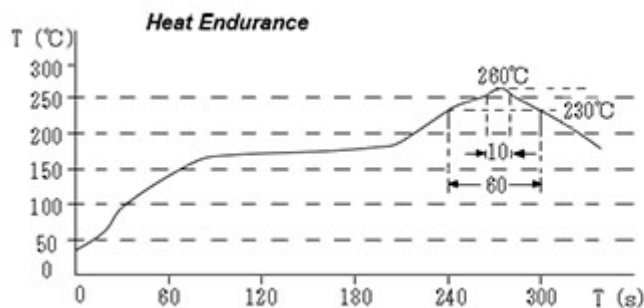

SMD Power Inductor

CDEPH6211



直流饱和电流&温度上升曲线图

— L (25°C) — L (100°C) — ΔT

1. CDEPH6211NP-R10LC

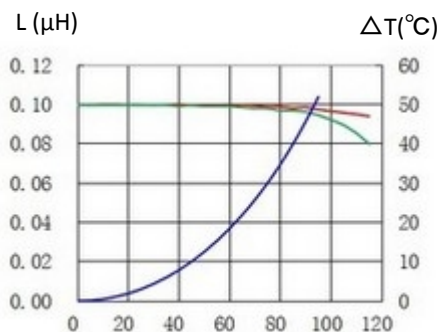

DC(A)

2. CDEPH6211NP-R12LC

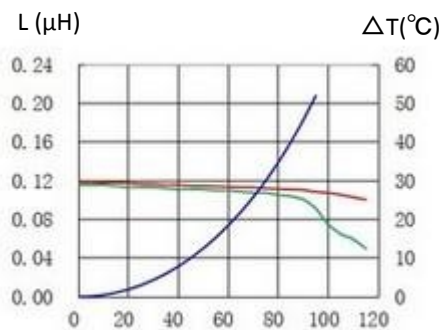

DC(A)

3. CDEPH6211NP-R15LC

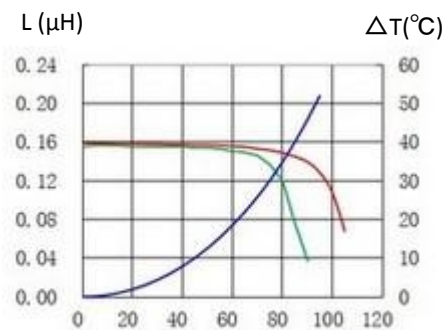

DC(A)

4. CDEPH6211NP-R32LC

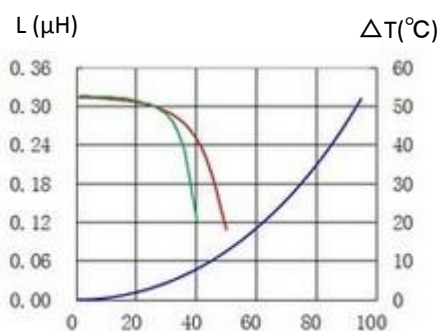

DC(A)



有关销售办事处的信息，请 [点击这里](#)。