

SMD Power Inductor

CDPH79D72



特点

- Ferrite core construction
- Magnetically shielded
- L×W×H: 8.8×8.2×7.5mm Max.
- Product weight: 1.87g(Ref.)
- Moisture Sensitivity Level: 1
- RoHS compliance

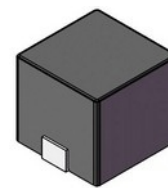

环境规格

- Operating temperature range: -40°C~+125°C (including coil's self temperature rise)
- Storage temperature range: -40°C~+125°C

包装

- Carrier tape and reel packaging
- 500pcs per reel

用途

- Filter choke for DC/DC converter
- Single and polyphase buck converter
- Input filter inductor for DC/DC converter

外形尺寸 - [mm]

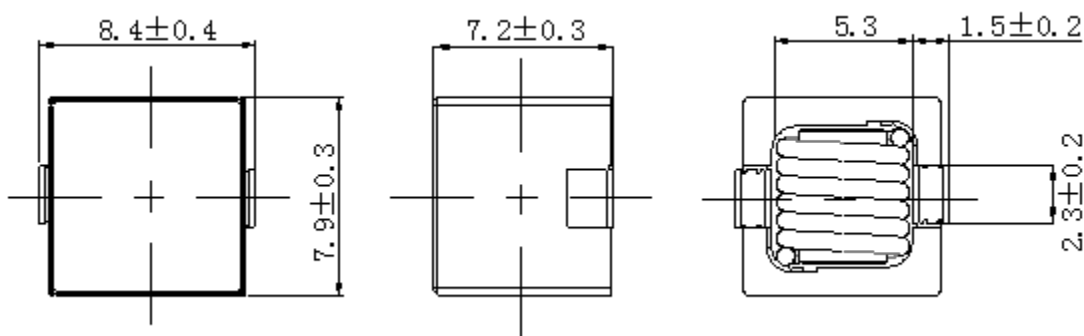

推荐焊盘尺寸 - [mm]

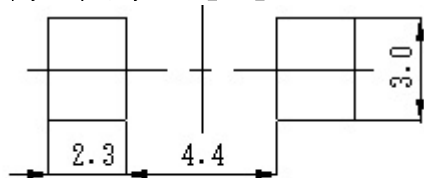

接线图 (底面)

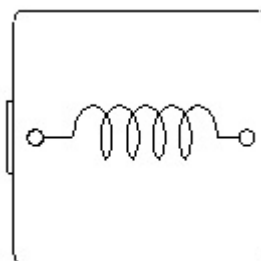

SMD Power Inductor

CDPH79D72



电气特性规格

品名	电感值 [within] (μ H) ※1	直流电阻 (20°C) Max. (Typ.) (m Ω)	饱和电流 (A) Max. (Typ.) ※2	温度上升电流 (A) Max. (Typ.) ※3
CDPH79D72NP-2R2MC	2.20 \pm 20%	(4.60)	10.00 (12.50)	(16.50)
CDPH79D72NP-6R8MC	6.80 \pm 20%	(22.50)	6.00 (7.50)	(5.50)

※1 Measuring condition: 100kHz.

※2 Saturation current: This indicates the value of D.C. current when the inductance becomes 30% lower than its initial value. (Ta=20°C).

※3 Temperature rise current: The value of D.C. current when the temperature of coil becomes $\Delta T=40^\circ\text{C}$. (Ta=20°C).

回流焊耐热与推荐温度曲线图

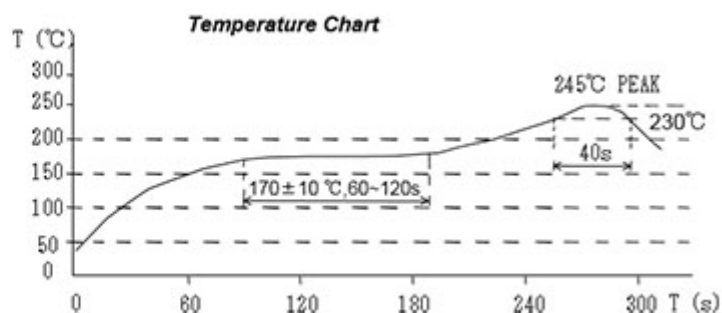
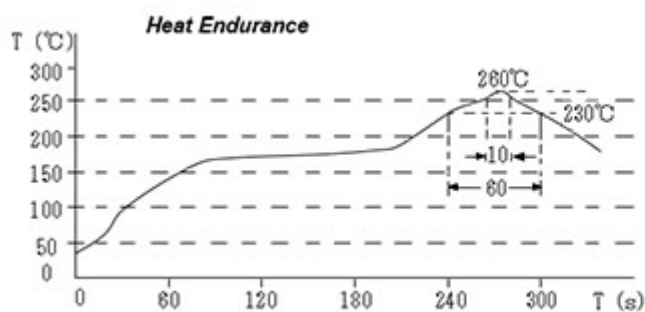

SMD Power Inductor

CDPH79D72



直流饱和电流&温度上升曲线图

— L (20°C) — ΔT

1. CDPH79D72NP-2R2MC

2. CDPH79D72NP-6R8MC

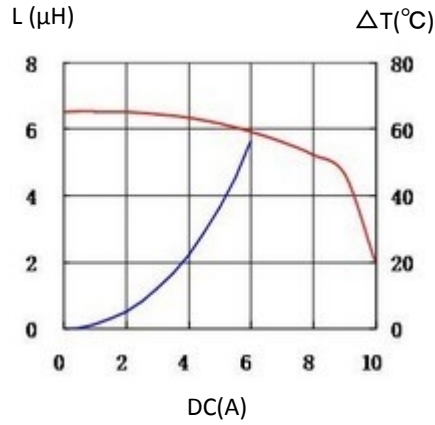
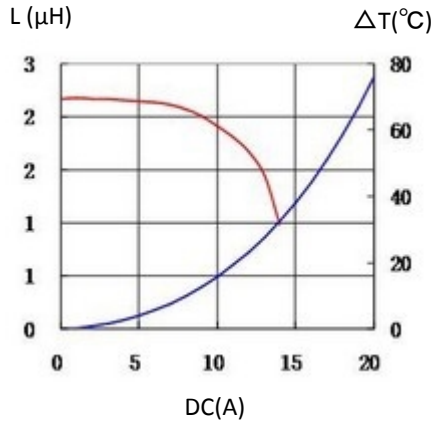

有关销售办事处的信息，请[点击这里](#)。